

# Bearings Direct.Com

## LME Linear Bushing with Seals - Metric Sizes

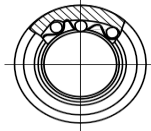
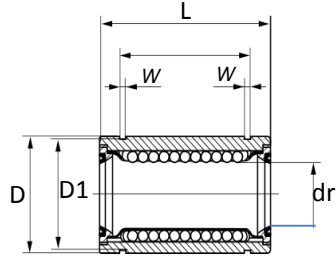

Nominal shaft dia.mm	Resinretainer		dr		Major Dimensions and Tolerance(T)										Eccentricity $\mu\text{M}$	Radial Clearance (max) $\mu\text{m}$	Basic Load Rating	
			mm	Tolerance $\mu\text{m}$		D		L		B		W mm	D1 mm	$\theta$			Dynamic CoN	Static CoN
	Precision	High		mm	T $\mu\text{m}$	mm	T $\mu\text{m}$	mm	T $\mu\text{m}$									
3	LME3	4	3	—	80	7	0-8	10	0-120	—	—	—	—	—	10	-3	69	105
4	LME4	4	4			8		12	—	—	—	—	—	—			88	127
5	LME5UU	4	5			12		22	14.5	0-200	0-200	1.1	11.5	—			206	265
8	LME8UU	4	8			16	25	16.5	1.1			15.2	—	265	402			
10	LME10UU	4	10			19	29	22	1.3			18	80°	372	549			
12	LME12UU	4	12	22	32	22.9	1.3	21	78°			510	784					
16	LME16UU	5	16	26	36	24.9	1.3	24.9	78°			578	892					
20	LME20UU	5	20	—	8	32	45	31.5	60°	862	1370							
25	LME25UU	6	25	—	10	40	0-11	58	0-300	0-300	1.85	37.5	60°	15	-6	980	1570	
30	LME30UU	6	30			47		68			52.1	1.85	44.5			50°	1570	2,740
40	LME40UU	6	40			62		80			60.6	2.15	59			50°	2160	4,020
50	LME50UU	6	50	—	11	75	0-13	100	0-300	0-300	2.65	72	50°	17	-8	3820	7,940	
60	LME60UU	6	60			90		125			101.7	3.15	86.5			54°	4,700	9,800