

SSW SERIES

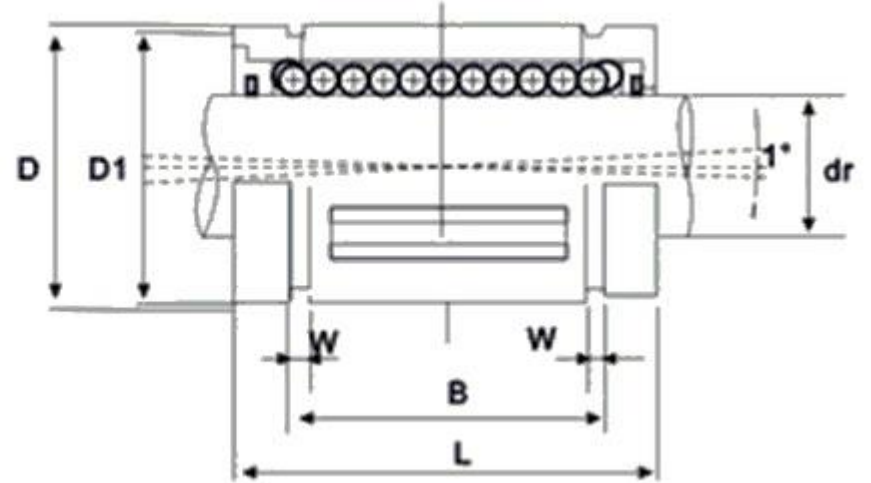
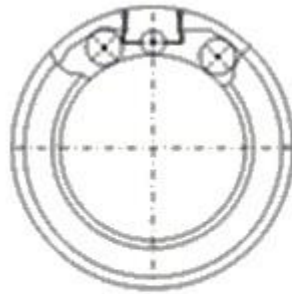

Part number		Major dimensions (Inches)									Basic load rating		
Bearing Number	Ball Circuit	dr		D	L		B		W	D1	Dynamic C lbs	static Co lbs	Nominal shaft diameter Inch
		Inch	Tolerance (Inch)		Inch	Tolerance	Inch	Tolerance					
SSW 6	4	.3750	0-.0005	.6250	.875	-.015	.703	-.015	.0390	.5880	95	120	3/8
SSW 8	4	.5000	0-.0005	.8750	1.250	-.015	1.032	-.015	.0459	.8209	230	290	1/2
SSW 10	5	.6250	0-.0005	1.1250	1.500	0-.020	1.112	0-.020	.0559	1.0590	400	500	5/8
SSW 12	6	.7500	0-.0005	1.2500	1.625	0-.020	1.272	0-.020	.0559	1.1760	470	590	3/4
SSW 16	6	1.0000	0-.0006	1.5625	2.250	0-.020	1.886	0-.020	.0679	1.4687	850	1,060	1
SSW 20	6	1.2500	0-.0006	2.0000	2.625	0/-.025	2.011	0/-.025	.0679	1.8859	1,230	1,530	1-1/4
SSW 24	6	1.5000	0-.0006	2.3750	3.000	0/-.030	2.411	0/-.030	.0859	2.2389	1,480	1,850	1-1/2
SSW 32	6	2.0000	0-.0008	3.0000	4.000	0/-.040	3.206	0/-.040	.1029	2.8379	2,430	3,040	2

SI Unit 1N=0.225 lbs

1kg=2.205 lbs

Bearings Direct.Com