

Flange Cartridge Units

UCFC 200 SERIES

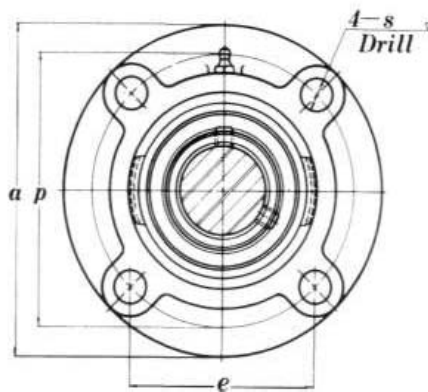
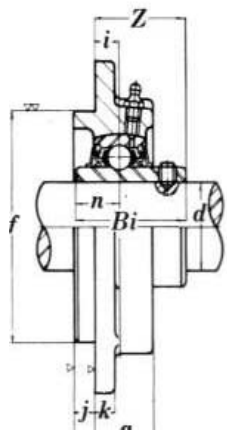

| UNIT No | Shaft Dim | | Dimensions (in) (mm) | | | | | | | | | | | | | BOLT SIZE | | Housing No |
|---|------------------------------------|----|----------------------|----------------|-----------------|-------------|---------------|-------------|-------------|-------------|---------------|-------------|-----------------|--------------|---------------|-----------|------|------------|
| | d | | a | p | e | i | l | s | j | k | g | f | z | Bi | n | mm | in | |
| | in | mm | | | | | | | | | | | | | | | | |
| UCFC201 UCFC201-8 | 1/2 | 12 | 3 15/16 100 | 3 5/64 78 | 2 11/64 55.1 | 25/64 10 | 1 25.5 | 15/32 12 | 13/64 5 | 9/32 7 | 13/16 20.5 | 2.45 62 | 1 1/8 28.3 | 1.23 31 | 0.5 12.7 | 10 | 3/8 | FC204 |
| UCFC202 UCFC202-18 | 5/8 | 15 | 3 15/16 100 | 3 5/64 78 | 2 11/64 55.1 | 25/64 10 | 1 25.5 | 15/32 12 | 13/64 5 | 9/32 7 | 13/16 20.5 | 2.45 62 | 1 1/8 28.3 | 1.23 31 | 0.5 12.7 | 10 | 3/8 | FC204 |
| UCFC203 UCFC203-11 | 11/16 | 17 | 3 15/16 100 | 3 5/64 78 | 2 11/64 55.1 | 25/64 10 | 1 25.5 | 15/32 12 | 13/64 5 | 9/32 7 | 13/16 20.5 | 2.45 62 | 1 1/8 28.3 | 1.23 31 | 0.5 12.7 | 10 | 3/8 | FC204 |
| UCFC204 UCFC204-12 | 3/4 | 20 | 3 15/16 100 | 3 5/64 78 | 2 11/64 55.1 | 25/64 10 | 1 25.5 | 15/32 12 | 13/64 5 | 9/32 7 | 13/16 20.5 | 2.45 62 | 1 1/8 28.3 | 1.23 31 | 0.5 12.7 | 10 | 3/8 | FC204 |
| UCFC205 UCFC205-14 UCFC205-15 UCFC205-16 | 7/8 15/16 1 | 25 | 4 17/32 115 | 3 35/64 90 | 2 1/2 63.6 | 25/64 10 | 1 1/16 27 | 15/32 12 | 15/64 6 | 9/32 7 | 13/16 20.5 | 2.76 70 | 1 5/32 29.7 | 1.34 34 | 0.56 14.3 | 10 | 3/8 | FC205 |
| UCFC206 UCFC206-18 UCFC206-19 UCFC206-20 | 1 1/8 1 3/16 1 1/4 | 30 | 4 29/32 125 | 3 15/16 100 | 2 25/32 70.7 | 25/64 10 | 1 7/32 31 | 15/32 12 | 5/16 8 | 5/16 8 | 29/32 23 | 3.15 80 | 1 9/31 32.2 | 1.5 38 | 0.625 15.9 | 10 | 3/8 | FC206 |
| UCFC207 UCFC207-20 UCFC207-21 UCFC207-22 UCFC207-23 | 1 1/4 1 5/16 1 3/8 1 7/16 | 35 | 5 5/16 135 | 4 21/64 110 | 3 1/16 77.8 | 7/16 11 | 1 11/32 34 | 35/64 14 | 5/16 8 | 11/32 9 | 1 1/32 26 | 3.55 90 | 1 7/16 36.4 | 1.69 42.9 | 0.689 17.5 | 12 | 7/16 | FC207 |
| UCFC208 UCFC208-24 UCFC208-25 | 1 1/2 1 9/16 | 40 | 5 23/32 145 | 4 23/32 120 | 3 11/32 84.8 | 7/16 11 | 1 13/32 36 | 35/64 14 | 25/64 10 | 11/32 9 | 1 1/32 26 | 3.94 100 | 1 5/8 41.2 | 1.94 49 | 0.75 19 | 12 | 7/16 | FC208 |
| UCFC209 UCFC209-26 UCFC209-27 UCFC209-28 | 1 5/8 1 11/16 1 3/4 | 45 | 6 5/16 160 | 5 13/64 132 | 3 43/64 94 | 7/16 11 | 1 1/2 38 | 5/8 16 | 15/32 12 | 9/16 14 | 1 1/32 26 | 4.12 105 | 1 19/32 40 | 1.94 49 | 0.75 19 | 14 | 1/2 | FC209 |
| UCFC210 UCFC210-30 UCFC210-31 | 1 7/8 1 15/16 | 50 | 6 1/2 165 | 5 7/16 138 | 3 27/32 97.6 | 7/16 11 | 1 9/16 40 | 5/8 16 | 15/32 12 | 9/16 14 | 1 3/32 28 | 4.34 110 | 1 11/16 42.6 | 2.04 52 | 0.75 19 | 14 | 1/2 | FC210 |
| UCFC211 UCFC211-32 UCFC211-34 UCFC211-35 | 2 2 1/8 2 3/16 | 55 | 7 9/32 185 | 5 29/32 150 | 4 11/64 106 | 33/64 13 | 1 11/16 43 | 3/4 19 | 15/32 12 | 19/32 15 | 1 7/32 31 | 4.93 125 | 1 13/16 46.4 | 2.19 56 | 7/8 22 | 16 | 5/8 | FC211 |
| UCFC212 UCFC212-36 UCFC212-38 UCFC212-39 | 2 1/4 2 3/8 2 7/16 | 60 | 7 11/16 195 | 6 19/64 160 | 4 29/64 113 | 43/64 17 | 1 7/8 48 | 3/4 19 | 15/32 12 | 19/32 15 | 1 13/32 36 | 5.32 135 | 2 7/32 57 | 2.56 65 | 1 25.4 | 16 | 5/8 | FC212 |
| UCFC213 UCFC213-40 | 2 1/2 | 65 | 8 1/16 205 | 6 11/16 170 | 4 47/64 120 | 5/8 16 | 1 31/32 50 | 3/4 19 | 35/64 14 | 19/32 15 | 1 27/64 36 | 5.7 145 | 2 3/16 58 | 2.56 65 | 1 25.4 | 16 | 5/8 | FC213 |
| UCFC214 UCFC214-44 | 2 3/4 | 70 | 8 15/32 215 | 6 31/32 177 | 4 59/64 125 | 43/64 17 | 2 1/8 54 | 3/4 19 | 35/64 14 | 23/32 18 | 1 9/16 40 | 5.9 150 | 2 13/32 62 | 2.94 75 | 1.19 30 | 16 | 5/8 | FC214 |
| UCFC215 UCFC215-48 | 3 | 75 | 8 21/32 220 | 7 1/4 184 | 5 1/8 130 | 45/64 18 | 2 7/32 56 | 3/4 19 | 5/8 16 | 23/32 18 | 1 9/16 40 | 6.3 160 | 2 15/32 63 | 3 77.8 | 1.32 33 | 16 | 5/8 | FC215 |

With Lubrication feature.